

Replacement Parts

ITEM	DESCRIPTION	CATALOG #
1	Lens Cap Assembly, Frosted	LCLCXX*
2	Screw	See LED Chart
3-5	Reflector	See LED Chart
6-9	LED Board	See LED Chart
10	Socket, 3-meter	752601
11	O-Ring	250028620000
12	Body	†
13	Base	†
14	O-Ring	250010280002
15	Screw, 1/4"-20 x 3/4"	250010290000
16	Subassembly	KFM050XX*
17	Screw, #10-24 x 3/8"	250013940000
18	Long Slot Spike (LSS)	250015840000
19	Stainless Steel Bracket	250026820000
20	Strain Relief Connector	250026840000
19-20	Bracket Mount Assembly	BM050XX**
21	Lock Ring (Order in Qty 25)	250030410000SP

\*XX = Finish code

\*\*XX = Finish code, powder-coat finish options only

†This part is not serviceable. Contact Customer Support or a local distributor to order a complete product.

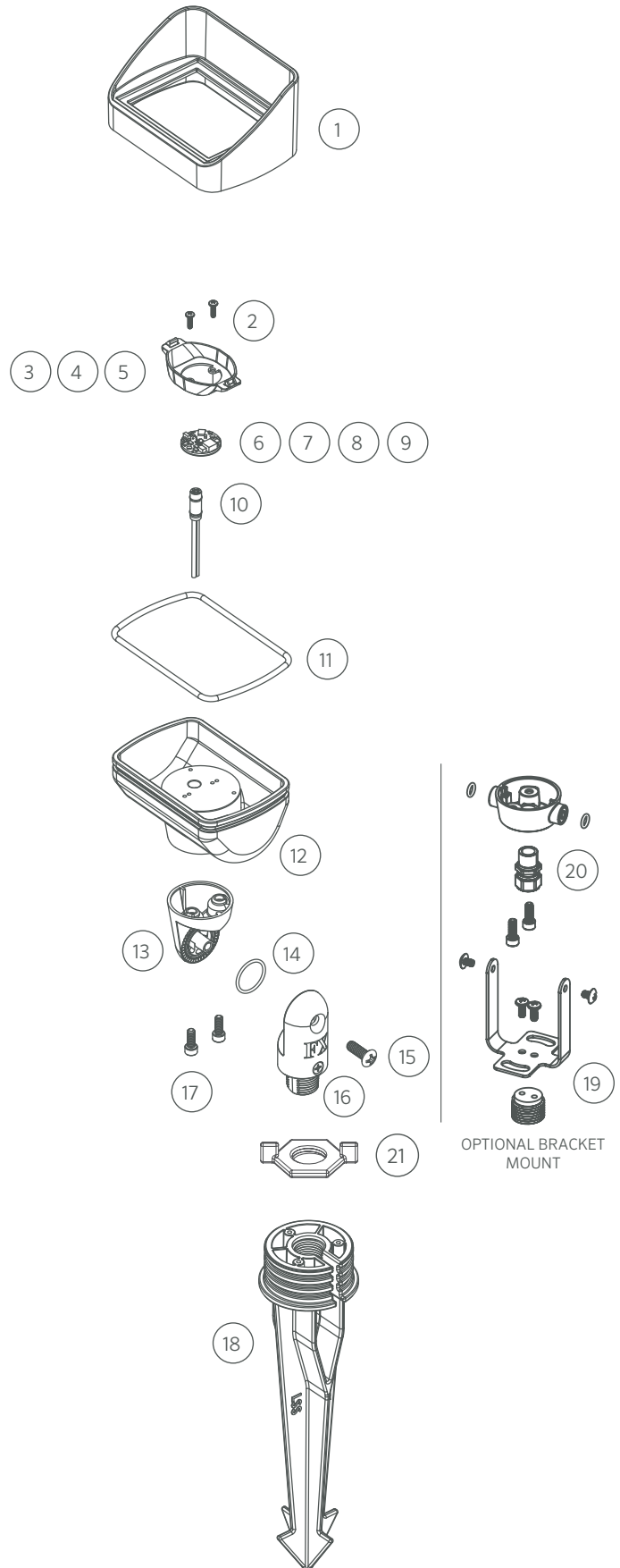

LED Chart

ITEM	DESCRIPTION	CATALOG #
2	1 LED/3 LED Screw, #4-40 x 3/8" (Qty: 2)	762400
2	6 LED/9 LED Screw, #4-40 x 7/16" (Qty: 3)	250014550000
3	1 LED Reflector	763000
4	3 LED Reflector	763100
4	ZDC LED Reflector	250020690000
5	6 LED/9 LED Reflector	250016450000
6	1 LED Board, 2nd Generation <sup>§</sup>	KIT1LEDRDW
7	3 LED Board, 2nd Generation <sup>§</sup>	KIT3LEDRDW
8	6 LED Board, 2nd Generation <sup>§</sup>	KIT6LEDRDW
9	9 LED Board, 2nd Generation <sup>§</sup>	KIT9LEDRDW
9	ZDC LED Board	ZDCKITL <sup>†</sup>

<sup>†</sup>ZDC Kit includes LED board and screws (#2). Order reflector (#4) separately.

<sup>§</sup>ZD = Zoneable and dimmable (add ZD to front of part number)

<sup>§</sup>For manufacturing date codes after February 1, 2022

1st Generation LED Chart

ITEM	DESCRIPTION	CATALOG #
	1 LED Board	1LEDULKIT <sup>†</sup>
	3 LED Board	3LEDULKIT <sup>†</sup>
	6 LED Board	6LEDULKIT <sup>†</sup>
	9 LED Board	9LEDULKIT <sup>†</sup>
	1 LED/3 LED Color Filter, Amber	763200
	1 LED/3 LED Color Filter, Blue	763201
	1 LED/3 LED Color Filter, Green	763202
	6 LED/9 LED Color Filter, Amber	250016560000
	6 LED/9 LED Color Filter, Blue	250016560001
	6 LED/9 LED Color Filter, Green	250016560002